

**Project Name: UNIVERSITY OF CALIFORNIA, MERCED
NORTH BOWL PARKING 2**

Project No.: 906550

ADDENDUM NO. 1
to the
CONTRACT DOCUMENTS
April 22, 2016

- I. Bidder acknowledges that it is the Bidder's responsibility to ascertain whether any Addenda have been issued and if so, to obtain copies of such Addenda. Bidder therefore agrees to be bound by all Addenda that have been issued for this bid.

This Addendum forms a part of the Contract Documents and modifies the original Bidding Documents. The following changes, additions, or deletions shall be made to the following documents as indicated and all other Contract Documents shall remain the same.

II. CLARIFICATIONS

A. PRE-BID QUESTIONS – Questions received from bidders and responses are as follows:

1. Q. What is the thickness of concrete side walk?
 - A. The legend on sheet C4.0 for the concrete sidewalk shall be modified to read: "4" P.C.C., 3,500 PSI at 28 days with broom finish over 6" Class II AB moisture conditioned to at least optimum and compacted to at least 95% relative compaction over 12" native soil scarified and moisture conditioned to at least 3% above optimum moisture content and compacted to 90% but not more than 95% relative compaction."
2. Q. Is type of fly ash a Class F?
 - A. Per Specification Section 03 32 00 2.2B, it shall be Class C.
3. Q. Is temporary fencing required?
 - A. Provide temporary fencing according to sheet C2.1 attached to this Addendum.
4. Q. If temporary fencing is required, provide location(s).
 - A. Provide temporary fencing according to sheet C2.1 attached to this Addendum.
5. Q. The subgrade preparation plans/specs have conflicting information 6" or 12"?
 - A. Subgrade preparation shall be 12".
6. Q. What is the risk level for SWPPP?
 - A. Level 1. UCM will provide inspections and perform the reporting per campus permit. Contractor to provide SWPPP submittal for approval prior to the start of Work.
7. Q. Is a prime coat required?
 - A. Prime coat is required.

8. Q. Please provide detail on drainage inlet.
 - A. Oldcastle Precast 1818-CB or approved equal. Oldcastle product literature attached to this Addendum.
9. Q. What is to happen with any excess material?
 - A. Any excess material shall be stockpiled in the area indicated on sheet C2.1 as the "temporary stockpile area".
10. Q. Does excess material get stock piled on site?
 - A. Any excess material shall be stockpiled in the area indicated on sheet C2.1 as the "temporary stockpile area".
11. Q. Please provide size and thickness of cobbles.
 - A. Cobbles shall be a blend of the following sizes: 50% 6-8", 25% 3-5", and 25% 2-3". The total thickness shall be a minimum of 8".
12. Q. Confirm header board material. Specs state steel, while plans state redwood.
 - A. Header boards shall be wood per Detail 10 on Sheet C7.0
13. Q. Please provide manufacturer and model number for removable bollards.
 - A. Premanufactured bollards will be acceptable provided they meet the same criteria shown in the details. Bollard manufacturer can be Hansford Industries, Inc. dba Viking Steel. (Jim Wright - j.wright@vikingsteel.net - 916-379-0210).
14. Q. Specs call out 44" of cover over pipe (page 5), while plans (C7.1, note #11) states 30". Pipe bedding - plan (C7.0 detail 3 and 4) call out 4" min., while sheet C7.1 Note #9, states 12. Please clarify.
 - A. The cover for the storm and fire shall be 44". Bedding shall be a minimum of 4" per details 3 and 4. C7.1 notes 9 and 11 apply only to domestic and fire water, does not apply to storm or irrigation.
15. Q. "Per Section 32 17 23 - Pavement Markings and Signs, page 5, Part 3 Execution, 3.2 Preparation, E-1 - Allow asphalt concrete to age for 30 days before starting pavement markings. Is the 30 days taken into account in the calendar day schedule, to have everything complete by September 1, 2016?"
 - A. The 30 days will be waived and the pavement parking may be installed in accordance with the paint manufacturer's recommendations for pavement curing.
16. Q. Is there any reinforcing in the sidewalks?
 - A. Yes, 6x6x10 mesh minimum shall be required with slip dowels at all cold joints.
17. Q. What is the design water pressure (PSI)?
 - A. Water pipe shall be Class 200. Water system serves domestic and fire protection lines.
18. Q. "Per Sheet C4.0 and the existing site conditions, there is a 2' gap between the existing and proposed parking lot. Please provide a detail showing the relationship of the existing parking lot with the new."
 - A. The 2' gap shall not exist. The existing wood header at the edge of phase 1 shall be removed and the new pavement shall match the existing pavement per the grading plan. The new curb stops on the new parking side shall be set 2 feet back from the edge of the existing parking lot.

19. Q. Please provide thickness of concrete at concrete walkways. Sheet C4.0 Legend calls for 6" AB over 12" native, but does not call out thickness of the concrete.
- A. Please reference question 01 above.
20. Q. Please provide thickness of concrete at valley gutter, from sheet C4.0
- A. Per Detail 6 on Sheet C7.0: 9" 3000 PSI P.C.C. over 8" Class II AB.
21. Q. Sheet C4.0 - What does the 56' x 20' area at the east end of the turnaround represent? The 56'x20' area represents a 12" native compacted soil ramp from the edge of the pavement to native grade. The area should be hydroseeded with the surrounding area.
- A. The 56'x20' area represents a 12" native compacted soil ramp from the edge of the pavement to native grade. The area should be hydroseeded with the surrounding area.
22. Q. Sheet C4.0 - Is the 56' x 20' area at the east end of the turnaround paved?
- A. No paving at this area, please reference question 21 above.
23. Q. Note 1, on the upper right of Sheet 3.0 "Roadways and Parking Stalls. Per Legend on Sheet C4.0 and C4.1". Sheet C4.1 is not included in the bid plans. Please clarify."
- A. Sheet C4.1 does not exist, ignore the reference.
24. Q. Per note on Sheet C2.1 - Existing gravel road shall remain accessible during construction and shall be kept free from any debris. Proposed Mineral King Road will be constructed once an alternate means of ingress/egress has been established by the Contractor for the existing Corp Yard." Will a base rock section in the new parking lot area provide adequate access to the Corp Yard?
- A. A minimum of 6" of compacted AB over prepared subgrade is acceptable as a means of access.
25. Q. If we are short on dirt to build up the parking lot, can we obtain the material from the adjacent areas next to the project?
- A. The site is intended to balance. Contractor to provide fill if needed.
26. Q. With the large amount of asphaltic concrete on the project and the volatile crude oil market, will the UC consider a payment adjustment for fluctuations for asphalt oil (increase or decrease of 5%), per Caltrans Specifications?
- A. Increases and decreases will not be accepted.
27. Q. Per the Utility Plans, Sheet C6.0, Existing drainage inlet to be adjusted to Rim Grade 235.50'. Is this correct? On the Grading Plan, Sheet C5.0, it is not showing provisions for a rim grade. If you average the two nearby grades, the new rim grade would be 230.5'.
- A. The proposed rim grade shall be adjusted 230.50. It was not shown on the grading plan because it is not a low point but shall still be adjusted to 230.50.
28. Q. Per Bid Form, page 7, 12.0, required completed attachments, item 4 - Exhibit 3 of the Key Personnel Schedule. Please provide additional information.
- A. Delete Bid Form. Use Bid Form attached to this Addendum.

III. **BIDDING/CONTRACT DOCUMENTS AND DIVISION 1 SPECIFICATIONS – VOLUME 0**

1. **Revise 01 71 23 Field Engineering:** Revise Field Engineering 01 71 23 specification. University will provide Field Engineering in accordance with the specification section.
2. **Revise Bid Form: Delete Bid Form.** Revise Bid Form to include 10x multiplier for daily compensable rate. Bid Form attached to this Addendum.

V. **DRAWINGS**

C2.1 Logistic Plan

Site Fencing Requirements

VI. **ATTACHMENTS**

- | | | |
|---|----------------------------|----------------|
| 1 | 01 71 23 Field Engineering | April 22, 2016 |
| 2 | Bid Form | April 22, 2016 |

UNIVERSITY OF CALIFORNIA, MERCED

By: University of California, Merced

Fran Telechea
Interim Director of Construction

End of Addendum No. 1

ADDENDUM NO. 1

BID FORM

FOR: NORTH BOWL PARKING PHASE 2
UNIVERSITY OF CALIFORNIA
MERCED CAMPUS, MERCED COUNTY
MERCED, CALIFORNIA

BID TO: DESIGN+CONSTRUCTION
UNIVERSITY OF CALIFORNIA, MERCED
767 E. YOSEMITE AVE., SUITE C
MERCED, CALIFORNIA 95340
TELEPHONE: (209) 228-4479

BID FROM:

(Name of Bidder)

(Address)

_____, _____
(City) (State) (Zip Code)

(Telephone Number)

(Date Bid Submitted)

Note: All portions of this Bid Form must be completed and the Bid Form must be signed before the Bid is submitted. Failure to do so will result in the Bid being rejected as non-responsive.

1.0 BIDDER'S REPRESENTATIONS

Bidder, represents that a) it, and all Subcontractors, regardless of tier, have the appropriate current and active Contractor's license required by the State of California and the Bidding Documents; b) it has carefully read and examined the Bidding Documents for the proposed Work on this Project; c) it has examined the site of the proposed Work and all Information Available to Bidders; d) it has become familiar with all the conditions related to the proposed Work, including the availability of labor, materials, and equipment. Bidder hereby offers to furnish all labor, materials, equipment, tools, transportation, and services necessary to complete the proposed Work on this Project in accordance with the Contract Documents for the sums quoted; e) Bidder and all Subcontractors, regardless of tier, are currently registered with the California Department of Industrial Relations pursuant to California Labor Code Section 1725.5 and 1771.1. Bidder represents that the Key Personnel identified in its Prequalification submittal shall be the Bidder's personnel provided pursuant to the corresponding provisions of the contract, if the contract is awarded to the Bidder. Bidder further agrees that it will not withdraw its Bid within **60** days after the Bid Deadline, and that, if it is selected as the apparent lowest responsive and responsible Bidder, that it will, within 10 days after receipt of notice of selection, sign and deliver to University the Agreement in triplicate and furnish to University all items required by the Bidding Documents. If awarded the Contract, Bidder agrees to complete the proposed Work within 153 days after the date for commencement specified in the Notice to Proceed.

2.0 ADDENDA

Bidder acknowledges that it is Bidder's responsibility to ascertain whether any Addenda have been issued and if so, to obtain copies of such Addenda from University's Facility at the appropriate address stated on Page 1 of this Bid Form. Bidder therefore agrees to be bound by all Addenda that have been issued for this Bid.

3.0 NOT USED**4.0 LUMP SUM BASE BID**

\$

--	--

 ,

--	--	--

 ,

--	--	--

 .

--	--

(Place figures in appropriate boxes.)

Bidder includes in the Option Sum – Phase 2, the following allowances:

\$20,000 for Allowance No. 1 Utilities as identified in Section 01 21 00.

\$50,000 for Allowance No. 2 Traffic Control as identified in Section 01 21 00.

5.0 SELECTION OF APPARENT LOW BIDDER

Refer to the Instructions to Bidders for selection of apparent low bidder.

6.0 UNIT PRICES - N/A

7.0 DAILY RATE OF COMPENSATION FOR COMPENSABLE DELAYS WITH TWO OPTIONS

Bidder shall determine and provide below the daily rate of compensation for any Compensable Delay caused by University at any time during the performance of the Work for Phase 2. (MINIMUM AMOUNT ALLOWED IS \$1.00)

\$

--	--

 ,

--	--	--

 •

--	--

 X 10 multiplier

(Place figures in appropriate boxes.)

Failure to fill in a dollar figure for the daily rate for Compensable Delay shall render the bid non-responsive. University will perform the extension of the daily rate times the multiplier.

The daily rate shown above will be the total amount of Contractor entitlement for each day of Compensable Delay caused by University at any time during the performance of the Work and shall constitute payment in full for all delay costs, direct or indirect, of the Contractor and all subcontractors, suppliers, persons and entities under Contractor on the Project, including without limitation all subcontractors added by Contract Amendment. The number of days of Compensable Delay shown as a "multiplier" above is not intended as an estimate of the number of days of compensable delay anticipated by the University. The University will pay the daily rate of compensation only for the actual number of days of Compensable Delay, as defined in the General Conditions; the actual number of days of compensable delay may be greater or lesser than the "multiplier" shown above.

8.0 ALTERNATES

In order for a Bid to be responsive, Bidder must submit an additive bid, a deductive bid, or a "no change" bid, for each Alternate listed below. The failure to do so shall result in the Bid being rejected as non-responsive. The failure to quote an amount, unless the bidder marks the "no change" box, will result in the bid being rejected as non-responsive.

The Contract Time will change by the number of days, if any, specified for each accepted Alternate

Deductive Alternate No. 1 **Section 01 23 00**

\$

--	--

 ,

--	--	--

 ,

--	--	--

 •

--	--

Deductive Alternate No. 2 **Section 01 23 00**

\$

--	--

 ,

--	--	--

 ,

--	--	--

 | •

--	--

9.0 LIST OF SUBCONTRACTORS

Bidder will use Subcontractors for the work included in this bid:

Yes _____

If "yes", provide in the spaces below (a) the name, the location of the place of business, and the California contractor license number of each subcontractor who will perform work or labor or render service to the prime contractor in or about the construction of the work or improvement, or a subcontractor licensed by the state of California who, under subcontract to the prime contractor, specially fabricates and installs a portion of the work or improvement according to detailed drawings contained in the plans and specifications, in an amount in excess of one-half of 1 percent of the prime contractor's total bid, (b) the portion of the work which will be done by each subcontractor. The prime contractor shall list only one subcontractor for each such portion as is defined by the prime contractor in its bid.

Portion of the Work Activity (e.g. electrical, mechanical, concrete)	Subcontractor		
	Name of Business	Location of Business (City)	License No.

10.0 LIST OF CHANGES IN SUBCONTRACTORS DUE TO ALTERNATES

The information below must be provided for all changes in first-tier Subcontractors if University selects Alternates. List changes in Subcontractors only for those portions of the Work valued in excess of one-half of 1 percent of prime contractor's total bid.

Alternate No.	Subcontractor			
	Portion of the Work Activity (e.g. electrical, mechanical, concrete)	Name	Location (City)	License No.

(Note: Add additional pages if required.)

11.0 BIDDER INFORMATION

TYPE OF ORGANIZATION:

(Corporation, Partnership, Individual, Joint Venture, etc.)

If a corporation, corporation is organized under the laws:

STATE OF

(State)

NAME OF PRESIDENT OF THE CORPORATION:

(Insert Name)

NAME OF SECRETARY OF THE CORPORATION:

(Insert Name)

If A PARTNERSHIP, NAMES AND TITLES OF PERSONS SIGNING THE BID ON BEHALF OF BIDDER
AND ALL GENERAL PARTNERS:

PERSONS SIGNING ON BEHALF OF BIDDER:

(Insert Names and Titles)

ALL GENERAL PARTNERS:

(Insert Names)

CALIFORNIA CONTRACTORS LICENSE(S):

(Classification)

(License Number)

(Expiration Date)

(For Joint Venture, list Joint Venture's license and licenses for all Joint Venture partners.)

12.0 REQUIRED COMPLETED ATTACHMENTS

The following documents are submitted with and made a condition of this Bid:

1. Bid security in the form of _____.
(Bid Bond or Certified Check)
2. If "Yes" in 9.0 above, a completed CM/Contractor Expanded List of Subcontractors form.
3. If "Yes" in 10.0 above, a completed CM/Contractor Expanded List of Subcontractors form identified as "LIST OF CHANGES IN SUBCONTRACTORS DUE TO ALTERNATES".
4. Exhibit 3 of Key Personnel Schedule

13.0 DECLARATION

I, _____, hereby declare that I am the
(Printed name)

_____ of _____
(Title) (Name of bidder)

submitting this Bid Form; that I am duly authorized to execute this Bid Form on behalf of Bidder; and that all information set forth in this Bid Form and all attachments hereto are, to the best of my knowledge, true, accurate, and complete as of its submission date.

I further declare that this bid is not made in the interest of, or on behalf of, any undisclosed person, partnership, company, association, organization, or corporation; that the bid is genuine and not collusive or sham; that the bidder has not directly or indirectly induced or solicited any other bidder to put in a false or sham bid, and has not directly or indirectly colluded, conspired, connived, or agreed with any bidder or anyone else to put in a sham bid, or that anyone shall refrain from bidding; that the bidder has not in any manner, directly or indirectly, sought by agreement, communication, or conference with anyone to fix the bid price of the bidder or any other bidder, or to fix any overhead, profit, or cost element of the bid price, or of that of any other bidder, or to secure any advantage against the public body awarding the contract of anyone interested in the proposed contract; that all statements contained in the bid are true; and, further, that the bidder has not, directly or indirectly, submitted his or her bid price or any breakdown thereof, or the contents thereof, or divulged information or data relative thereto, or paid, and will not pay, any fee to any corporation, partnership, company association, organization, bid depository, or to any member or agent thereof to effectuate a collusive or sham bid.

I declare, under penalty of perjury, that the foregoing is true and correct and that this declaration was executed at: _____ (Name of City if within City, otherwise Name of County), State of _____

_____, on _____.
(State) (Date)

(Signature)

SECTION 01 71 23
FIELD ENGINEERING

PART 1 - GENERAL

1.1 PREPARATION

- A. Lay out and install all Work to lines and grades in accordance with Contract Documents.

1.2 LAYOUTS AND MEASUREMENTS

- A. Surveyor shall provide all survey Work required for horizontal and vertical location of all Work in this Project as applies to their scope of work.
- B. Contractor shall be responsible for paying for the replacement and reestablishment of control stakes, monuments, and lines furnished by the University that are destroyed or disturbed by General Contractor' construction activities. The University shall provide the following
 - 1. Establish site benchmarks
 - 2. Provide pad certification
 - 3. Establish all building corners, 6 column lines in the north-south direction, 2 column lines in the east-west and 4 elevation benchmarks at locations directed by the University's Representative prior to excavation
 - 4. Reestablish the above following excavation and prior to the start of foundations.
- C. Surveyor shall furnish the University's Representative, prior to Project acceptance, 2 complete sets of the field notes for the survey Work and cut sheets in addition to 2 sets of drawings marked showing all deviations from Project alignment and grades as applies to their scope of work.
- D. Generally, grades shall match adjacent surfaces, and existing flow lines shall be maintained.

1.3 SURVEY REFERENCE POINTS

- A. Surveyor shall locate and protect control points prior to beginning the Work, and preserve all permanent reference points throughout construction operations. The Surveyor shall:
 - 1. Do not change reference points without prior approval of the University's Representative.
 - 2. Report to the University's Representative when any reference point is lost, destroyed, or requires relocation due to necessary changes in grades or locations.

1.4 PROJECT SURVEY REQUIREMENTS

- A. Surveyor shall establish lines and levels, locate, and lay out for own work.
- B. Surveyor shall provide layouts as Work proceeds to assure compliance with required schedules, lines, levels, and tolerances for own work.

ADDENDUM 1
APRIL 22, 2016

1.5 RECORDS

- A. Surveyor is required to maintain a complete and accurate log of all control and survey Work as it progresses for own work.

1.6 SUBMITTALS

- A. Upon request by the University's Representative, the Surveyor shall submit documentation to verify accuracy of field engineering Work.

PART 2 - PRODUCTS (NOT USED)

PART 3 - EXECUTION (NOT USED)

END OF SECTION 01 71 23

ADDENDUM 1

Site Fencing
Fencing shall safe off the existing parking area from construction.
Gates and site access are the responsibility of the Contractor.
Contractor shall move the fence as necessary during construction to perform the Work.
Contractor shall provide a Site Logistic Plan for UCM review and approval prior to Work.

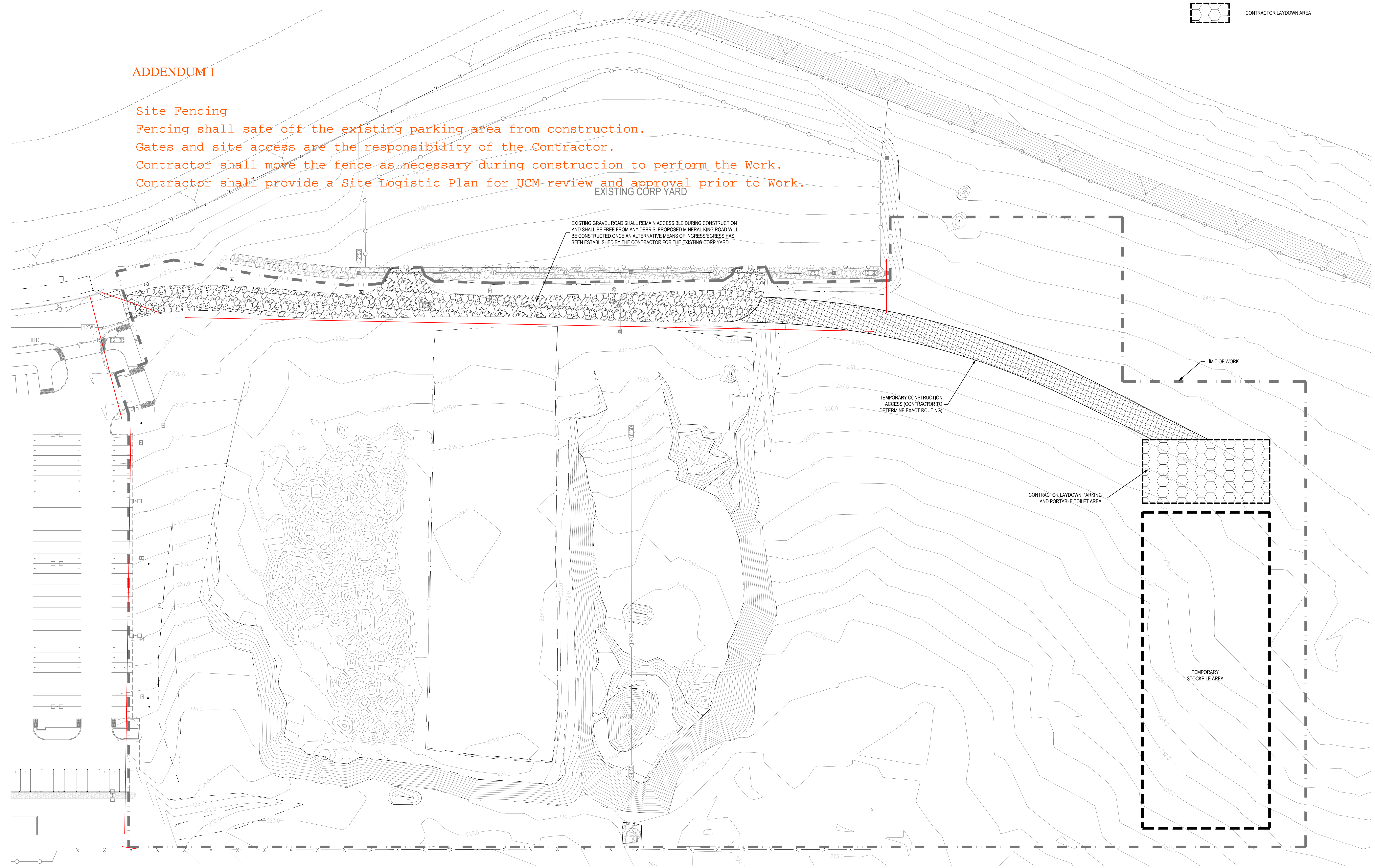

LEGEND

- EXISTING GRAVEL ROAD
- TEMPORARY CONSTRUCTION ACCESS
- CONTRACTOR LAYDOWN AREA

ADDENDUM 1

THIS PLAN
FOR REFERENCE ONLY

UC

Merced

University of California
Merced, California

Project Name:

North Bowl
Parking
Phase 2

Project Number:

906550

Engineer:

SIEGFRIED
3044 Brookside Road, Suite 100
Stockton, California 95219
209-943-2021
www.siegfriedeng.com

CIVIL
ENGINEERING

STRUCTURAL
ENGINEERING

LAND
SURVEYING

LANDSCAPE
ARCHITECTURE

UNIVERSITY OF CALIFORNIA MERCED
FIRE MARSHAL
CDF-OFFICE OF STATE FIRE MARSHAL
APPROVED

Approval of this plan does not authorize or
approve any omission or deviation from
applicable regulations. Final approval is subject
to field inspection. One set of approved plans
shall be available on the project at all times.

Reviewed By:

Project #:

Authorization #:

Seal and Signature

PATRICIA SCHMIDT
No. 62488
Exp. 09/30/17
CIVIL
STATE OF CALIFORNIA

DATE SIGNED: 03/31/16

IDENTIFICATION STAMP
DIVISION OF THE STATE ARCHITECT

APPL 01
AC _____ FLS _____ SS _____
DATE _____

Drawing Stage:

100% CONSTRUCTION
DOCUMENTS

No.

Description

Issue Date

Drawn By:

Revision Date:

Plot Date:

Scale:

Key Plan:

0" 15' 30' 60'

Drawing Title

LOGISTIC PLAN
FOR REFERENCE ONLY

Drawing Number:

C2.1